

Rev No.	Description of Revision	Date	Name	Approved	ECN No.
△ X 1	HOUSING RESIN 변경(PA9T GW2458 -> LCP L304T40)	2007.10.03	J.K.PARK		071003-1
△ X	CARD 삽입형개선및 CARD STOPPER 강도개선	2008.06.03	J.K.PARK		
△ X 3	CARD STOPPER 강도개선	2008.12.15	B.S.LEE		081112-01

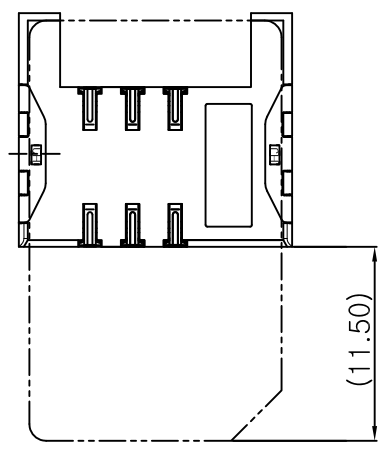
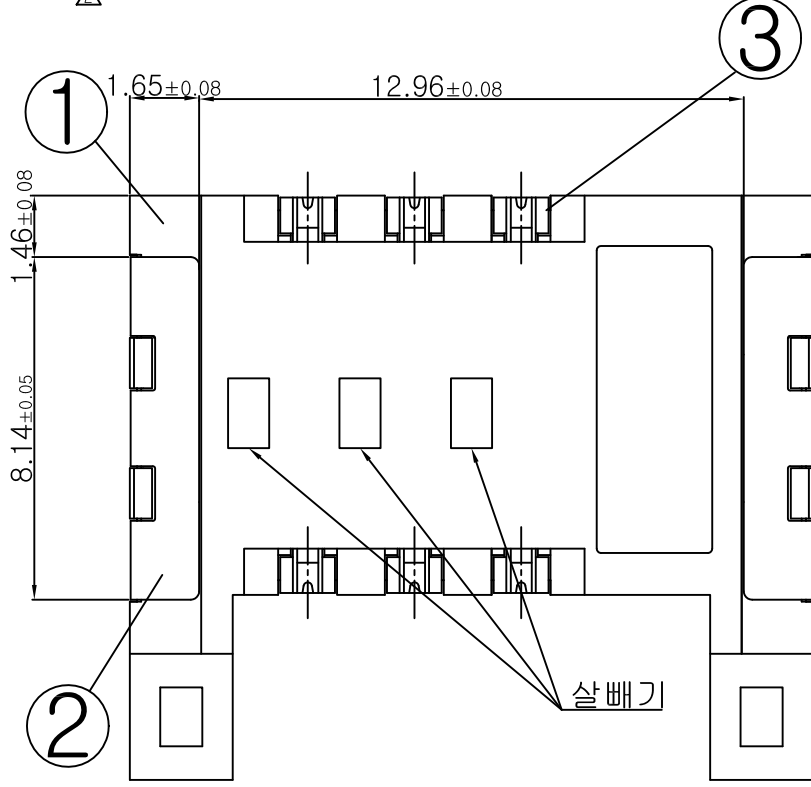
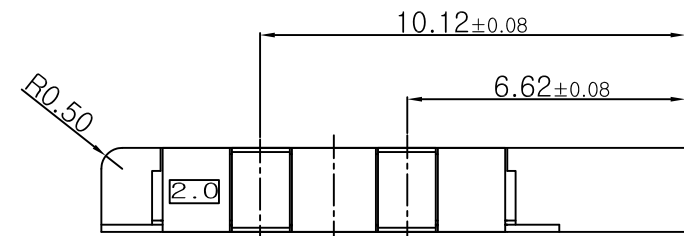
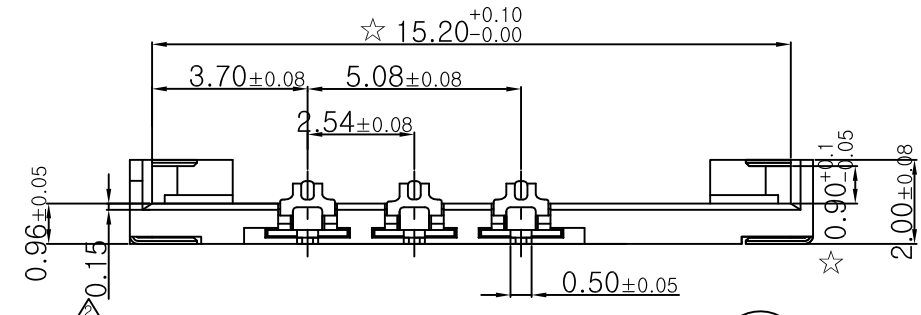
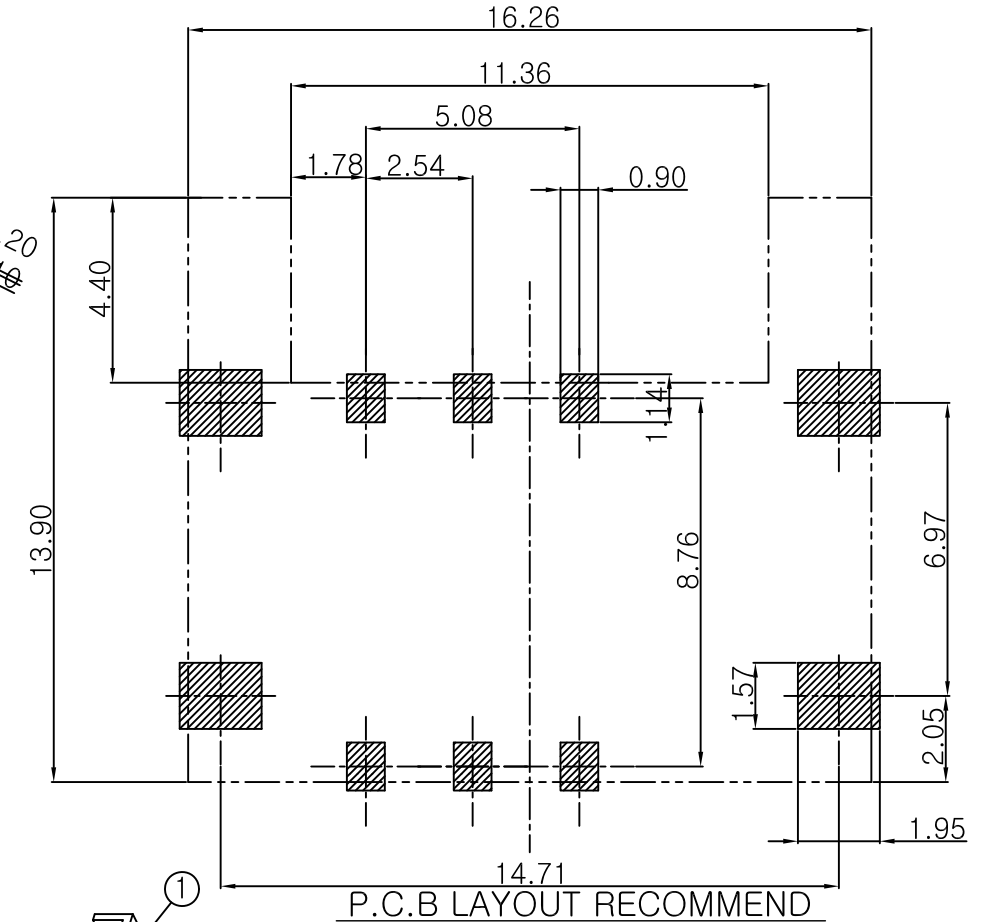
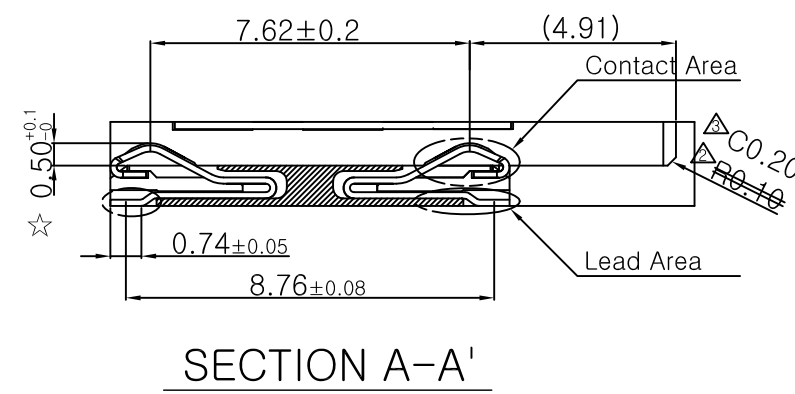
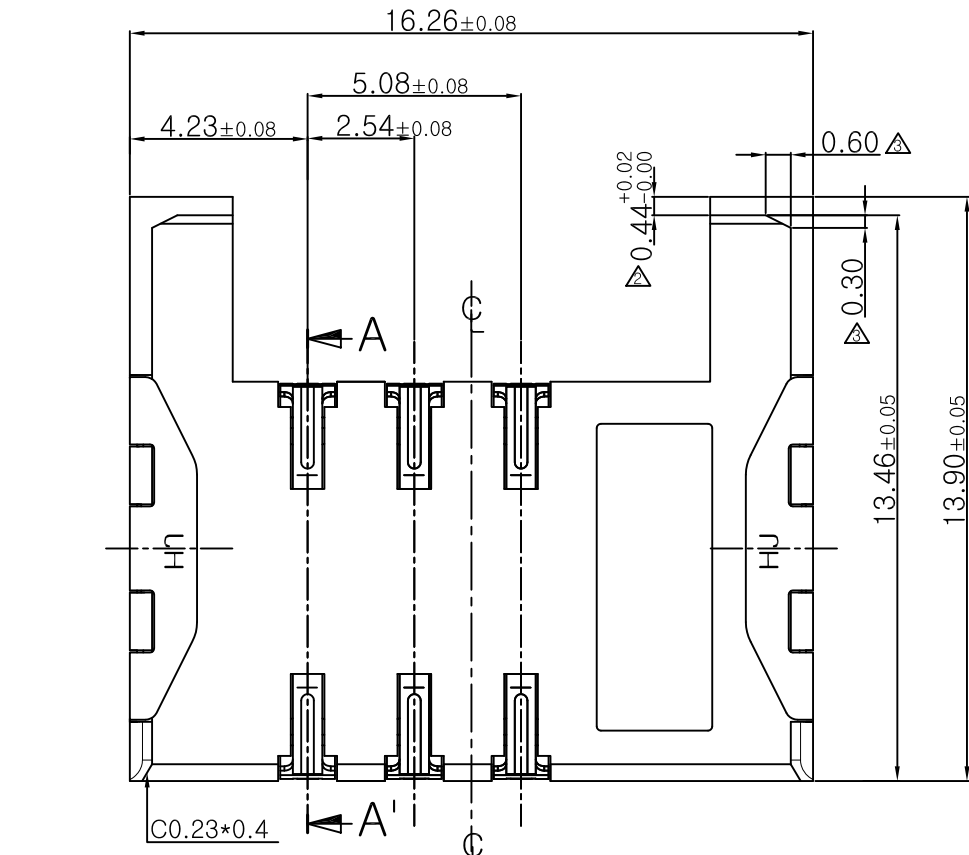

※ Specifications

- Voltage Rating : 30V_{AC/DC}
- Current Rating : 1.0A/Pin
- Operating temperature : -30℃~+80℃
- Contact Retention Force : 80±20gf
- Durability : Vertical Test - 5,000 cycles Min.
Card Test - 1,000 cycles Min.

-NOTE-

- Plating
 - Contact: Contact Area : Au 0.3μm Min over Ni 1.0~5.0μm
Lead Area : Au 0.05μm Min over Ni 0.2~3.0μm.
 - Metal Cover : Ni 1.0~5.0μm.
- ☆ = C.T.Q

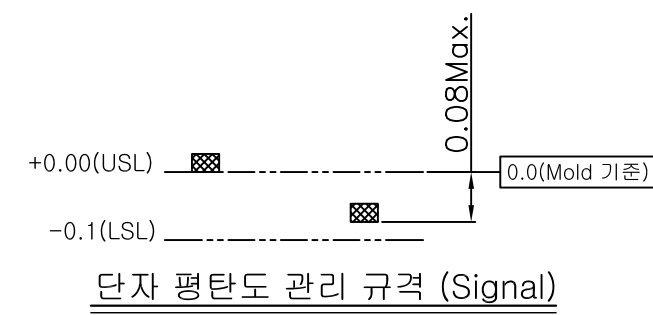

No	Descriptions	Material	Finish	Remarks
3	CONTACT TER	C17530	Note	t0.15
2	METAL COVER	STS304	Note	t0.15
1	HOUSING	△ LCP(L304T40) - PA9T	Black Color	-

General Tolerance		Scale	Units	Sheet	TITLE	SIM CONNECTOR 5000-6P-2.0S
Dimension	mm (°)	Date	mm	1 of 1		
X	± 0.2	2006. 09. 21			Customer Drawing	Rev.
X.X	± 0.1					
X.XX	± 0.05				SW No. 5000-6P-2.0S.dwg	3
X.XXX	± 0.01					
ANGLE	± 1°	HJ&C HYUP JIN I&C CO., LTD.				

단자 평탄도 관리 규격 (Signal)